

SPECIFICATIONS
 FREQUENCY
 VSWR
 INSERTION LOSS
 ISOLATION

4 - 8 GHz
 2.0:1 (MAX) 1.5:1 (TYP)
 1.0 dB (MAX) .7 dB (TYP)
 13Db (MIN) 16 dB (TYP)

REVISIONS

REV	DESCRIPTION	DATE	APPROVED
.			

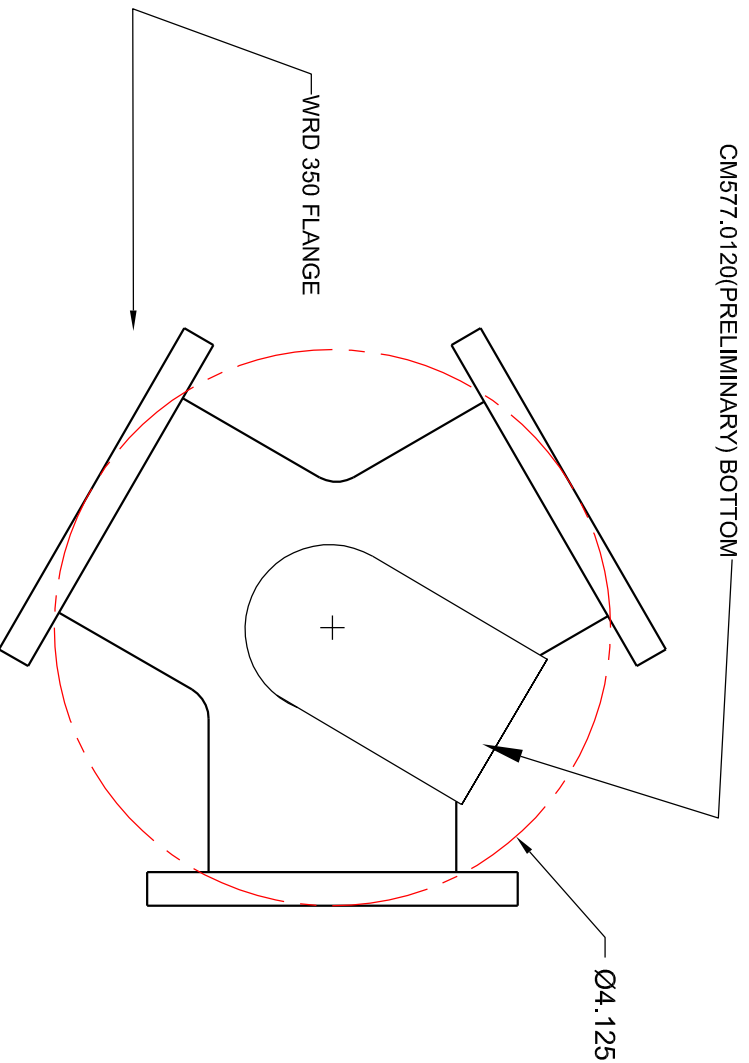

NOTE:

- 1.
- 2.
- 3.

<p>CONNECTICUT MICROWAVE CORPORATION 1486 HIGHLAND AVE. CHESHIRE, CONNECTICUT 06410</p>		<p>ASSEMBLY WRD350 CIRCULATOR</p>		<p>TOLERANCES</p>		<p>DECIMAL</p>	<p>FRACTIONAL</p>	<p>ANGULAR</p>	<p>SURFACE FINISH</p>	<p>REV</p>	<p>DATE</p>	<p>MATL</p>
				<p>(EXCEPT AS NOTED)</p>	<p>±.005</p>	<p>+ 1/64</p>	<p>+ 1/2 DEG</p>	<p>32</p>	<p>.</p>	<p>7/12/02</p>	<p>6061 - T6</p>	

CM577.0100